

Site Plan Legend

- EXTENT OF HEAVY DUTY ASPHALT
- EXTENT OF ASPHALT
- EXTENT OF CONCRETE
- NEW FIRE HYDRANT
- LIGHT POLE
- PROPERTY LINE
- SETBACK LINE
- URW
- CHAINLINK FENCE
- EXISTING WATER
- EXISTING SANITARY
- EXISTING STORM
- LOADING STALL
- LOCATION OF NEW TRANSFORMER - SEE DP E1.0
- WASTE AND RECYCLING ENCLOSURE - REFER TO DP A1.2
- SIAMSE CONNECTION - REFER TO CIVIL DRAWING C02
- BIKE RACKS
- FLAG POLES
- BOLLARDS SEE 4/A1.02
- BARRIER FREE RAMP SEE 6/A1.02
- CONCRETE CURB SEE 10/A1.02

**NW Francophone, K - 6
Site Data**

Landuse Classification: BPR
 Legal Address: Plan 8311360, Block 2, Lot 19MSR
 Municipal Address: Scenic Acres Drive N.W., Calgary, Alberta
 Total Site Area: 9.82 acres (39,575m² or 9.85 hectares)
 Building Classification: Group A - Division 2

Building Area: (City of Calgary Calculation)
 Main Floor: 3,530.00 m² 37,898.00 f²
 Core: 2,825.00 m² 30,408.00 f²
 Modules: 725.00 m² 7,890.00 f²
 Mechanical Room: 115.00 m² 1,240.00 f²
Gross Floor Area: 3,845.00 m² 41,436.00 f²

Parking Calculation:
 Parking: 1.0 stalls per 15 students (K-6)
 Required: 27 Stalls (400 Students)
 Provided: 27 Stalls (400 students)
 Pick-up & Drop-off: 2.5 pickup & drop-off stalls per 100 students.
 Required: 10 stalls
 Provided: 10 stalls
 Loading: 1 Loading stall
 Required: 1 Stall
 Provided: 1 Stall
 Bicycles: Class 1: 3% Employees
 Class 2: 10% Students
 Provided: Class 1: 2
 Class 2: 40 (400 students)
 Class 1: 2
 Class 2: 40

Building Area: (Alberta Infrastructure Calculation)
 TOTAL AREA: 2,760.00 m² 29,635.00 f²
 Main Floor Core: 2,760.00 m² 29,708.00 f²
 Modules: 8 Type A @ 120m² each
 Mechanical Room: 114.00 m² 1,227.00 f²

Revisions: Date: Description:

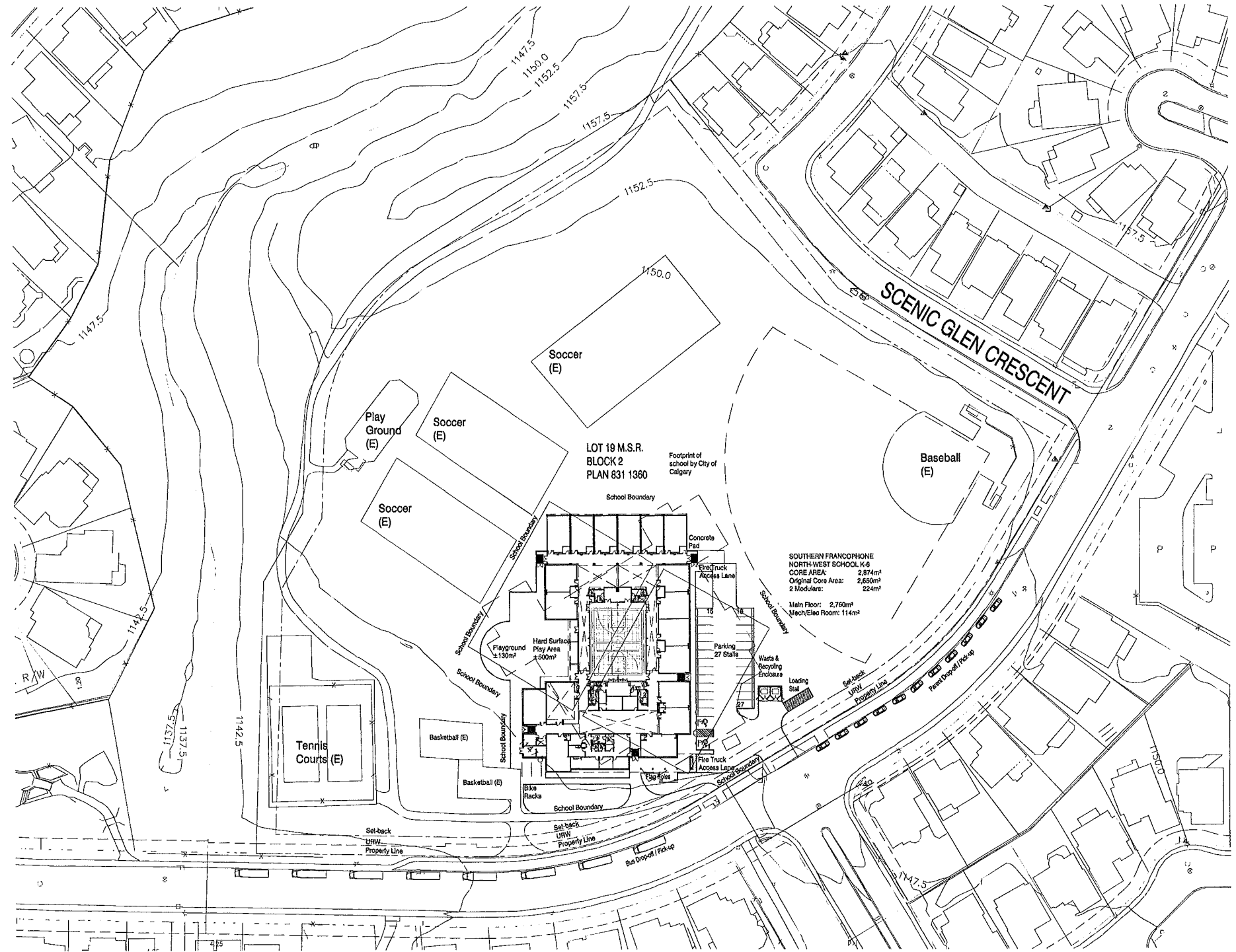

SITE PLAN

Calgary, SFER, NW Francophone K-6

Scenic Acres Drive, Calgary, Alberta



Issued for Development Permit

Issue Dates:
 1. Issued for Development Permit 2014/07/04
 2. :
 3. :
 July 04, 2014

SITE PLAN
 1:500

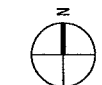

A1.1